

PRODUCT CATALOGUE

2025



G9X

4G|5G

TOOL 



**R1600.00**

| Retail Excl. VAT  
**5000 Unit +**

LET US HELP YOU MIGRATE TO 4G

THE G9X IS OUR MOST AFFORDABLE  
4G LTE SMARTPHONE | 4+4/64G

G9 LITE

TOOL 



**R1200.00**

I Retail Excl. VAT  
5000 Unit +



LET US HELP YOU MIGRATE TO 4G

THE G9 LITE IS OUR MOST AFFORDABLE  
4G LTE SMARTPHONE | 3+3/32G

WHEN YOU FINALLY UNDERSTAND YOUR WORTH, YOU BEGIN TO LIVE A FULFILLING LIFE AND YOU LEARN TO EMBRACE EVERYTHING ABOUT YOURSELF

## BRINGING THE WORLD BACK HOME

When the world knows you more than you know yourself; it is a tragedy. We live in a continent of amazing opportunities. Our success remains embedded in our ability to understand our worth as a society. That way we are able to see how much of our wealth is leaving Africa on daily basis. Even though we are still in our infancy. Our foundation is solid and our future is guaranteed. Our greatest asset is our vision and the value we have for the African continent as a dynamic market. Our patience has delivered us to a perfect time. A period where the world is a click away and data being the new golden egg. Today the entire population needs a smart phone to run their lives. As a communication technology company, we seek to bring efficient, secure and innovative products that are affordable to all demographics of our region.

**TOOL TECHNOLOGIES** brings a brand that will not only empower us as a society; but a brand that will touch and unite Africa from the tip of her toes to the longest thread of her hair. Our company does not just understand the African market. We are the market we serve.

**TOOL TECHNOLOGIES | KAYADIRECT (PROPRIETARY) Limited** was incorporated and registered Eswatini in 2023 and 2024 in South Africa. It is in the same year that we managed to consolidate our relationship with our smart phone manufacturer and outlined our first product catalogue. Apart from smart phones, TOOL is a bouquet of amazing electronic products tailored for the diverse African Market.

Established by now Executive Director | Marketing , Mfundvo Mndzebele; this indigenous brand comes to a market in need of local participation. A brand that understands the fundamental needs of the society it serves. We have already set a strong plan that will help us participate effectively in uplifting our community. Launching at least a dozen models; ranging from 4Gb to 24Gb of RAM with a maximum of 512Tb ROM. We are geared to win a significant market share in our first year. We truly agree that Africa is a ready market, but our initial focus will be the SACU region. The common customs region, will play a significant role in our gradual growth plan. With approximately 15 mobile networks and a vast number of retail groups; this region can propel us to greater heights.

**TOOL TECHNOLOGIES** is an **ESCCOM** registered and licensed tech and electronics company, Eswatini. [www.toolte.com](http://www.toolte.com)



GRAND SPECS | AMAZING PRICES



| MODELS  | TOOL'G100  | TOOL'G100 PRO   |
|---|--|---|
|  <p>Body :</p> |  |  |
| Main Features:  | 6.75" 90Hz<br>7.9mm<br>5000mAh   | 6.9" 120Hz<br>8.1mm<br>6000mAh<br>NFC   |
| Size:   | 167.2x77x7.9mm 189g  | 171x77.6x8.1mm 205g   |
| Colour:   | Black/Green/White  | Black/White/Blue  |
| Chipset:  | MTK G36 8Core 12nm<br>2xA53 2.2 GHz 6xA53 1.6 GHz                                  | UNISOC T615 8-Core 12nm 2xA75 1.8 GHz 6xA55 1.6 GHz                                 |
| Memory:   | 6GB + 128GB  | 8+256GB   |
| Display:  | 6.75" Water Drop 90Hz/HD+/1600x720   | 6.9" Water Drop 120Hz/HD+/1640x720  |
| Rear Camera :   | 50MP +2MP+ 2MP   | 50MP +2MP+ 2MP  |
| Front Camera :  | 8MP  | 16MP  |
| Battery:  | 5000mAh(typ)   | 6000mAh(typ)  |
| Charging:   | 10W Charger  | 20W Charger   |
| Ports:  | Type-C(USB 2.0) / OTG / 3.5mm  | Type-C(USB 2.0) / OTG / 3.5mm   |
| Cellular & Wireless:  | 4G/3G/2G/Wi-Fi 2.4G/5G/GPS / FM / BT 5.4   | 4G/3G/2G Wi-Fi 2.4G/5G GPS / FM / BT 5.0  |
| NFC:  | NFC  | NFC   |
| Unlock:   | Side Fingerprint & FACE ID   | Side Fingerprint & FACE ID  |
| OS:   | Android 14   | Android 14  |
| Price:  | 6GB+128GB  | 8+256GB   |

Kindly note that all specifications will be confirmed on quotation and priced duly.

360° 4K 120FPS

| MODELS  | TOOL'NOTE 100  | TOOL'RHINO  |
|---|--|---|
|  <p>Body :</p> |  |  |
| Main Features:  | 6.9" 120Hz<br>8.1mm<br>6000mAh   | 6.75" 90Hz<br>7.9mm<br>5000mAh  |
| Size:   | 171x77.6x8.1mm 205g  | 167.2x77x7.9mm 189g   |
| Colour:   | Black/Titanium   | Black/Green/White   |
| Chipset:  | Unisoc T765 8Core 6nm 2xA76 2.3 GHz 6xA55 2.1 GHz                                  | MTK G36 8Core 12nm<br>2xA53 2.2 GHz 6xA53 1.6 GHz                                   |
| Memory:   | 12+256GB   | 6GB + 128GB   |
| Display:  | 6.9" (6.88) Water Drop 120Hz/HD+/1640x720  | 6.75" Water Drop 90Hz/HD+/1600x720  |
| Rear Camera :   | 50MP +2MP+ 2MP   | 50MP +2MP+ 2MP  |
| Front Camera :  | 16MP   | 8MP   |
| Battery:  | 5000mAh(typ)   | 6000mAh(typ)  |
| Charging:   | 20W Charger  | 10W Charger   |
| Ports:  | Type-C(USB 2.0) / OTG / 3.5mm  | Type-C(USB 2.0) / OTG / 3.5mm   |
| Cellular & Wireless:  | 5G/4G/3G/2G / Wi-Fi 2.4G/5G / GPS / FM / BT 5.0                                    | 4G/3G/2G/Wi-Fi 2.4G/5G/GPS / FM / BT 5.4  |
| NFC:  | NFC  | NFC   |
| Unlock:   | Side Fingerprint & FACE ID   | Side Fingerprint & FACE ID  |
| OS:   | Android 15   | Android 14  |
| Price:  | 12+256GB   | 6GB+128GB   |

Kindly note that all specifications will be confirmed on quotation and priced duly.

360 1513 13002

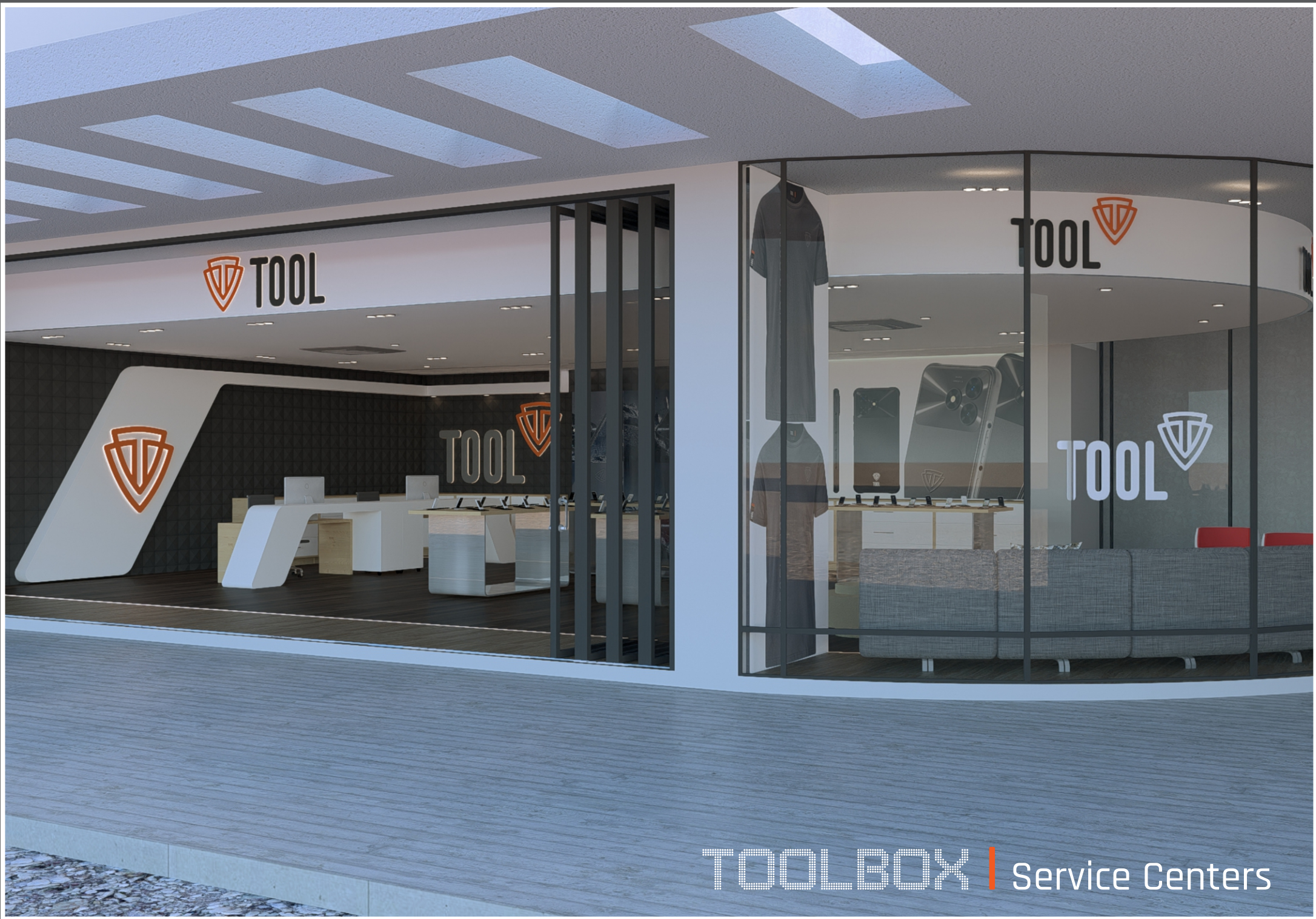

TOOLBOX | Service Centers

**KAYADIRECT** (PROPRIETARY) LIMITED | **South Africa**  
T/A TOOL TECHNOLOGIES | [mytool@toolte.com](mailto:mytool@toolte.com)  
Direct Mobile: +2771.70 70 727

**MFUNDVO MNDZEBELE**  
EXECUTIVE MARKETING DIRECTOR  
[mfundvo@concorse.com](mailto:mfundvo@concorse.com)  
Mobile: +268.7666 0 666  
WhatsApp: +268.76 111 111



TOOL TECHNOLOGIES IS AN ESCCOM REGISTERED AND LICENSED  
TECHNOLOGY AND ELECTRONICS COMPANY IN ESWATINI | [GECS/003/23/TOOLTECH](https://www.gecs.gov.sz/003/23/TOOLTECH)

[WWW.CONCORSE.COM](http://WWW.CONCORSE.COM)